

EQUIPMENT NEEDED IN USING

EAS HARD TAG, CONE PLASTIC PIN, MAGNETIC DETACHER



DETACH THE PIN

A magnetic detacher is needed to detach the pin from the hard tag.

1. Put the extrusive part of the hard tag onto the center of the magnetic detacher, let the blue plastic part of the pin face to yourself.



2. Use your finger to hold the plastic part of the pin, take the pin out from the hard tag. Detaching process is then to be completed.

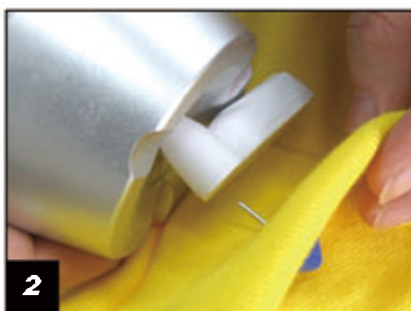

HOW TO PROTECT THE COMMODITIES

One EAS hard tag and cone plastic pin for one commodity. Please make sure the hard tag and pin are separated.

1. Choose a part on the commodity, put the cone plastic pin across this part.



2. Use a hard tag, let the part which has a needle hole to face the pin.



3. Insert the pin shaft into the needle hole of hard tag, till the tag and pin are completely closed.

